



Evergreen Drive, West Drayton, Middlesex, UB7 9GH

- Drayton garden village
- Unfurnished
- On site supermarket
- Three bedroom house
- Available for February
- EPC Rating- B

£2,350 PCM

Cameron Estate Agents are delighted to offer this modern three bedroom house in the popular Drayton Garden Village Development. Boasting from modern interior through-out including a separate kitchen with base & eye level units, downstairs W.C, large reception room, family bathroom upstairs and a en-suite bathroom. Externally there is a private rear garden and off street parking. The Development is an entirely new neighbourhood that adopts traditional 'Garden City' principles, where everyone can enjoy gardens and tree-lined avenues in a community with amazingly good connections. The development is only a short walk to the Town Centre with its wide selection of popular independent shops as well as excellent transport links to Heathrow International Airport and the M4 and M25 motorways. West Drayton Elizabeth train line provides frequent services to London Paddington. Available for February and presented unfurnished.

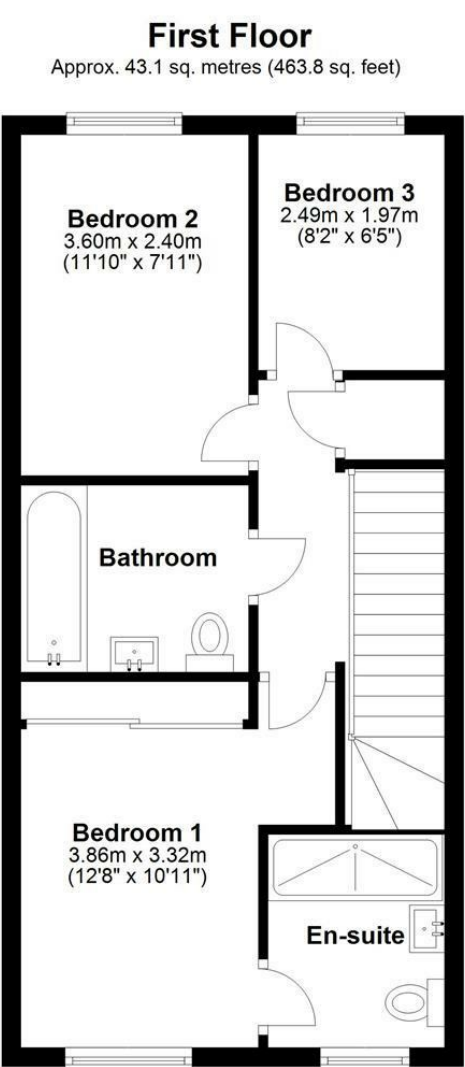
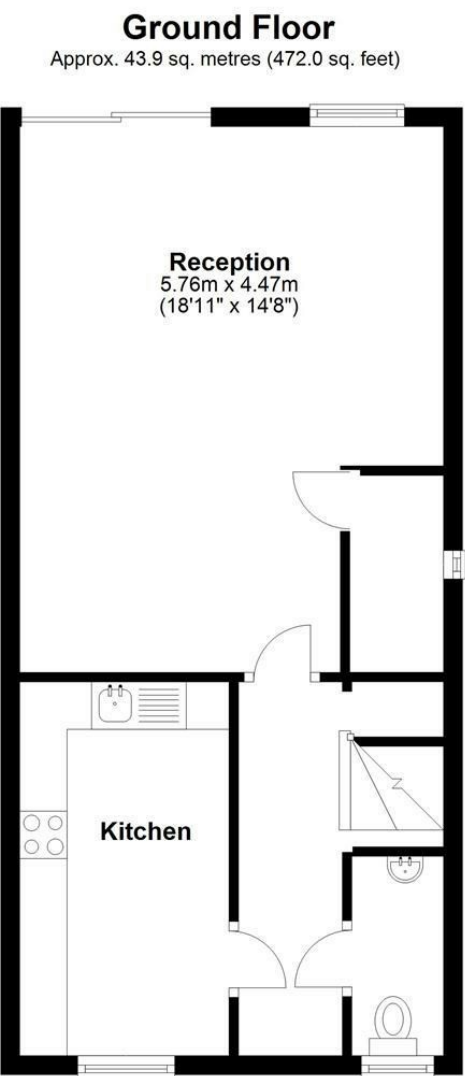

Total area: approx. 86.9 sq. metres (935.9 sq. feet)

IMPORTANT NOTICE

These particulars have been prepared upon information supplied by the Vendor and should be verified by your surveyors and solicitors. We have prepared these sales particulars as a general guide to give a broad description of the property. They are not intended to constitute part of an offer or contract. We have not carried out a structural survey and the services, appliances and specific fittings have not been tested. All photographs, measurements, floor plans and distances referred to are given as a guide only and should not be relied upon for the purchase of carpets or any other fixtures or fittings. Lease details service charge and ground rent (where applicable) are given as a guide only and should be checked and confirmed by your solicitor prior to exchange of contracts